

Storage

When cool, the Sandwich Maker may be stored upright. Loose Toasting Plates should be stored in a protective wrapping to avoid scratching.



Cautions

- This appliance is not intended for use by persons (including children) with reduced physical, sensory or mental capabilities or lack of experience or knowledge, unless they have been given supervision or instruction concerning use of the appliance by a person responsible for their safety.
- Otherwise, always keep the unit out of the reach of children.
- Before use, check that your mains power supply corresponds to the voltage shown in this manual (also shown on the rating plate).
- Do not connect the Mains Plug ⑦ into your socket with wet hands.
- Unplug the appliance whenever it is not in use.
- Never leave the unit unattended when it is operating.
- The Mains Lead ⑨ should be positioned so as not to cause an obstruction or to overhang the edge of the surface, where it could accidentally snagged or pulled by children.
- Ensure that the Mains Lead ⑨ is not near any hot surface.
- Pull the Plug (do not pull Mains Lead) ⑨ to disconnect from mains socket.
- As the appliance becomes hot to the touch during operation always handle with care.
- The appliance should only be used only as instructed: there is potential for injury from misuse.
- Do not switch on or attempt to operate the appliance if it appears to be faulty in any way - contact Judge customer services at the address given in the warranty section.
- Never attempt to make any repair to the appliance yourself - contact Judge customer services at the address given in the warranty section.
- Do not immerse the Sandwich Maker in water to clean.
- Make sure that all surfaces that come into contact with food are kept scrupulously clean. Wipe work surfaces before and after use with an antibacterial cleaner.
- Please keep your purchase receipt.

Specification

Name	Model No.	Power Supply	Rated Power	Capacity
Judge Sandwich, Grill & Waffle Maker	JEA59	220 - 240V, 50/60Hz	750W	2 sandwiches or other pieces



Judge 2 Year Domestic Electrical Guarantee

The Judge Guarantee covers the product to be free of defects in materials and workmanship for a period of TWO YEARS from the date of original retail purchase. During this period, JUDGE will, at their discretion, repair or replace defective parts of the product, or replace the product, providing the Use Care and Safety Advice have been followed.

The Guarantee does not cover damage, defect or failure caused by or resulting from accidents, external damage, alteration, modification, abuse, misuse or misapplication.

The Guarantee does not cover any damage caused by taking the appliance apart yourself, or attempting to repair the appliance yourself.

THE PRODUCT IS INTENDED FOR DOMESTIC USE ONLY.

Please keep your Purchase Receipt and contact us directly if you encounter any problems with your product.

HORWOOD SHALL NOT BE LIABLE FOR INCIDENTAL OR CONSEQUENTIAL DAMAGES RESULTING FROM THE USE OF THIS PRODUCT (INCLUDING COLOUR FADING, SCRATCHES OR ACCUMULATED DIRT) WITHOUT FOLLOWING THE USE, CARE & SAFETY INSTRUCTIONS.

Note: Due to the introduction of improvements from time to time, the right is reserved to supply products which differ slightly from those illustrated and described in this publication.

Errors and Omissions Excepted.

JUDGE CUSTOMER SERVICES, HORWOOD, AVONMOUTH WAY, BRISTOL, BS11 9HX, GREAT BRITAIN

customerservice@horwood.co.uk

www.judgecookware.co.uk

Tel: 0117 940 0000



CORRECT DISPOSAL OF THIS PRODUCT

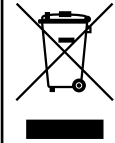

This marking indicates that this product should not be disposed with other household wastes throughout the EU. To prevent possible harm to the environment or human health from uncontrolled waste disposal, recycle it responsibly to promote the sustainable reuse of material resources. To return your used device, please use the return and collection systems or contact the retailer where the product was purchased. They can take this product for environmental safe recycling.

FOR DOMESTIC USE ONLY



JUDGE

Sandwich, Grill & Waffle Maker



Instruction Manual

Model No. JEA59

PLEASE READ THIS INSTRUCTION MANUAL CAREFULLY BEFORE USE AND KEEP FOR LATER REFERENCE.

UNPACK YOUR SANDWICH MAKER CAREFULLY AND REMOVE TEMPORARY PACKING PIECES, LABELS, STICKERS AND SWINGTICKETS.

Identifying the parts

(with Part Numbers for customer replaceable items)

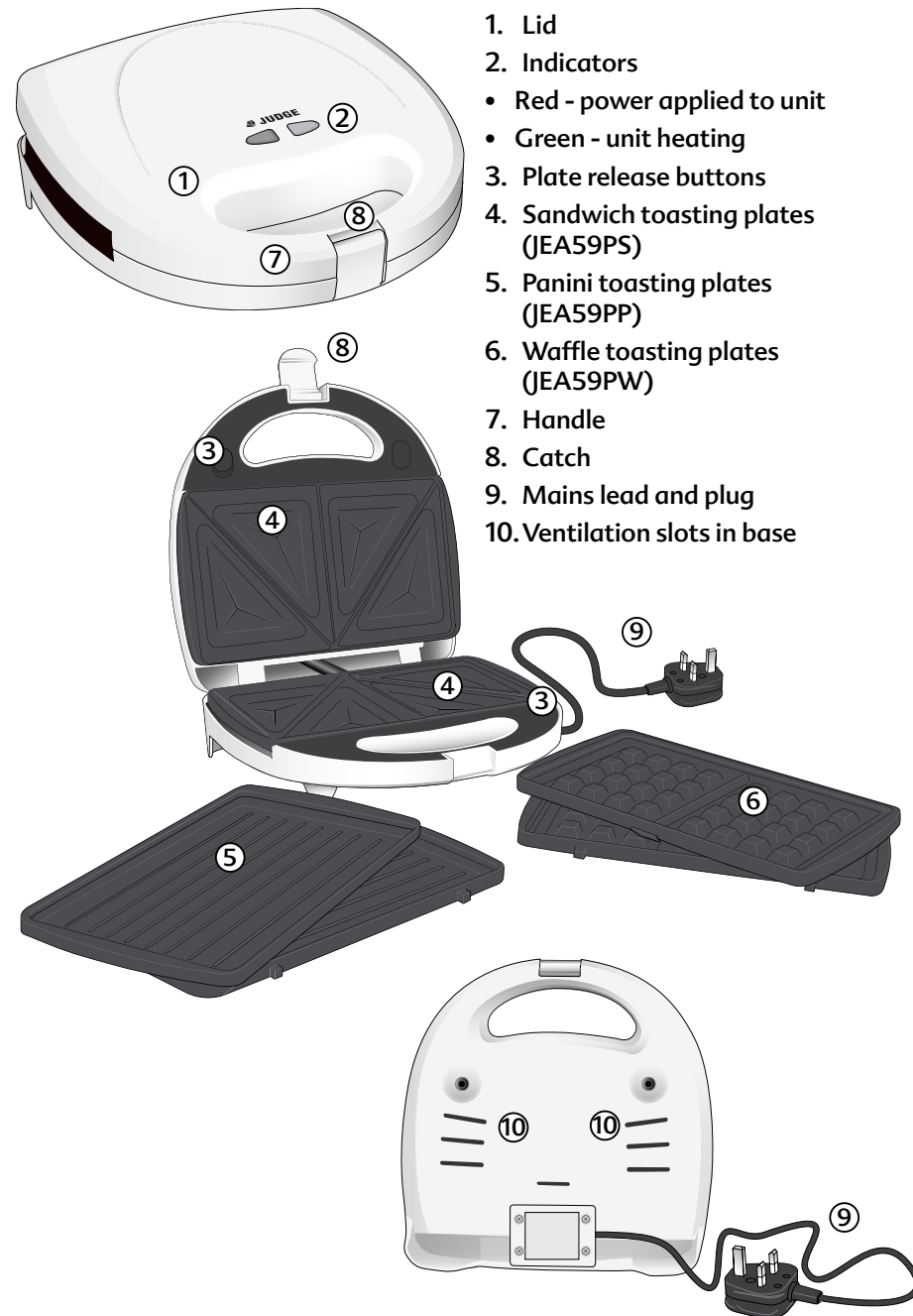

1. Lid
2. Indicators
 - Red - power applied to unit
 - Green - unit heating
3. Plate release buttons
4. Sandwich toasting plates (JEA59PS)
5. Panini toasting plates (JEA59PP)
6. Waffle toasting plates (JEA59PW)
7. Handle
8. Catch
9. Mains lead and plug
10. Ventilation slots in base

Before first use

The Sandwich Maker needs to be operated once before use, to remove any manufacturing taint.

1. Open the Sandwich Maker by using the Catch (8) at the centre of the Handle (7). Brush or wipe a small amount of cooking oil onto the Sandwich Toasting Plates (4). Insert two suitable slices of bread, so that the toasting plates are covered but not exceeded.
2. Close the Lid (1), secure the Catch (8) and connect the Mains Plug (9) to the mains supply; both indicators (2) will illuminate. Leave the appliance on for approximately 5 minutes (you will notice that the green indicator will extinguish when the toasting temperature is reached).
3. Switch off the power, open the Closing Catch (8) and discard the toast.
 - It is normal for smoke and smells to be emitted during this operation - manufacturing residues are being removed.
4. Allow the Sandwich Maker to cool. Release the Sandwich Toasting Plates (4), using the Plate Release Buttons (3), as indicated by an arrow on each button.
5. Repeat the above procedure for the Panini Toasting Plates (5) and Waffle Toasting Plates (6), using suitable food product.
- To insert an alternative toasting plate in the Sandwich Maker, locate the two rear lugs in slots in the hinge assembly then gently press the front of the plate until it clicks home.

How to use

The Sandwich Maker should be sited on a dry, level and stable surface, away from direct heat. The Mains Lead (9) should be positioned so as not to cause an obstruction or to overhang the edge of the surface.

1. Open the Sandwich Maker by using the Catch (8) at the centre of the Handle (7).
2. Select and fit the desired Toasting Plates (see Before First Use for fitting)
 - The toasting plates must be used in matching pairs.
3. Close the Lid (1) and connect the Mains Plug (9) to the mains supply; both indicators (2) will illuminate. Leave the appliance to heat up until the Green Indicator (2) extinguishes, indicating that the toasting temperature has been reached.
4. Once the Green Indicator (2) extinguishes, place the food product on the Toasting Plates (4, 5 or 6).
 - The food must not extend beyond the edges of the Toasting Plates. Trim if necessary to ensure that it is correctly contained.
5. GENTLY BUT FIRMLY close the Lid (1) until you feel the Catch (8) click into place. DO NOT FORCE THE LID DOWN.
 - Toasting time is a matter of taste, but will usually be about four minutes.

- Your Sandwich Maker toasts both sides of the food product at the same time and seals in the flavour. In most cases, sandwiches will be cut in half by the built-in cutter. Sometimes separation with a knife is needed.
- If a filling has spread onto the Non Stick Toasting Plates and food proves difficult to remove, the food may be removed using a heat resistant plastic spatula. Do not use metal tools, as these will scratch the Non Stick coating.

Tips

- Always use your Sandwich Maker at the correct toasting temperature (when the Green Indicator (2) extinguishes).
- To make golden toasted sandwiches, lightly butter the outside of the sandwich - place the filling between the unbuttered sides. If you intend to toast sandwiches which are not buttered on the outside, the Toasting Plates (4) may have to be lightly re-coated with cooking oil, butter or margarine between toasting.
- Use 'harder' cheeses such as Cheddar - processed cheeses tend to 'run' under high temperature.
- A little sugar sprinkled onto the buttered sides makes the toasted sandwiches crispier.
- Use only butter or ordinary margarine when preparing your food. Synthetic or low fat spreads are unsuitable, as they can cause the food to stick.
- For best Waffle results, we suggest to use a minimum cooking time of 10 minutes

Toasted sandwich ideas

The Sandwich Maker will allow you to invent a long list of favourite fillings, although specially dedicated cookbooks are readily available. Remember before you include them as a filling, meats must be pre-cooked (for example bacon), and some vegetables you may prefer to be pre-cooked (for example onion).

Here's a simple CHEESE TOMATO & ONION FILLING to get you started, sufficient for 4 - 6 sandwiches:

- Match the size of the bread to the size of the Toasting Plate sections.
- Thinly butter the outside of the bread.
- 250 ml grated Cheddar or other 'hard' cheese
- 1 large tomato, chopped and drained
- 1 onion, chopped and lightly fried
- Salt, pepper to taste. Mix with a fork

Cleaning and Storage

Switch OFF at the mains socket, remove the Mains Plug (9) and allow the Sandwich Maker to cool thoroughly before handling.

- Wipe the Toasting Plates with an absorbent cloth. Wipe the outside with a damp soapy cloth, and dry with a soft cloth. **DO NOT USE STEEL WOOL, SCOURING PADS OR ABRASIVE CLEANERS - INSIDE OR OUTSIDE.**
- Toasting Plates may be washed in the top shelf of a dishwasher.
- **DO NOT IMMERSE THE SANDWICH MAKER IN WATER.**